

Thank you for your interest in the workshop, “**Integrating Public and Ecosystem Health Systems to Foster Resilience: Identifying Research to Bridge the Knowledge-To-Action Gap**”. As you prepare to attend the workshop in person at the National Academies’ Keck building ([500 Fifth St. NW, Washington DC, 20001](#)), *please note the following important information and let us know if you have any comments or questions in advance of the meeting:*

COVID-19 Policies

Effective April 8, 2022, all facilities of the National Academies of Sciences, Engineering, and Medicine are **open**.

To prevent infection and spread of the COVID-19 virus, and as an integral measure towards the safety and health of everyone in our buildings, the National Academies require that **all visitors to our facilities be up-to-date on their vaccinations against COVID-19 per CDC guidance**. Additionally, do not enter the building if you have flu-like symptoms.

Visitors must show their official COVID-19 Vaccination Record Card (or a digital photo of the card) before entering any National Academies building, including parking facilities.

Anyone who fails to present this vaccination record will not be allowed access to our facility; no exemptions or exceptions will be accommodated. For more details regarding access to NASEM facilities and expectations for visitors, please visit our [operating status](#) webpage.

If you test positive for COVID-19 recently after attending the workshop in-person, please contact Kyle Aldridge (KAldridge@nas.edu) so that the National Academies can contact other workshop participants who may have been exposed. No personal information will be shared.

All workshop participants are strongly encouraged to wear a mask while indoors at the NAS building unless eating or drinking. Please consider using an at-home rapid COVID test the night before or morning of the workshop. The HVAC system in the building is equipped with MERV-13 air purifiers—the highest grade that is compatible with our system—and additional air purifiers (Corsi-Rosenthal boxes) will be running in the room while the workshop is taking place. A limited number of surgical and KN95 masks will be available on site.

The National Academies’ leadership is closely monitoring the evolving situation related to the COVID-19 pandemic, and is basing their approach to National Academies’ business on the current scientific evidence on COVID-19 and the best public health advice. The priority of the National Academies is the safety of our staff and our larger community of volunteers, sponsors, and members. Please be mindful that this may require unanticipated adjustments to events associated with National Academies projects.

• **Nearest pharmacy and COVID-19 test sites** to the Keck building are two CVS locations ([655 K St. NW](#) and [1275 Pennsylvania Ave. NW](#)). Each is about 11-12 minute walk away and offer COVID testing by appointment. Please note there may be a cost associated with the tests.

Getting to the Keck Center building and workshop

Parking and entrance

- Entrance to the conference areas in the Keck Building is through the main entrance 500 Fifth Street and the Visitor's Entrance on the P1 garage level. Conference rooms are located on the first floor and second floors. During normal business hours (7:30 a.m. to 5:30 p.m.), either entrance may be used. A security attendant will be present to direct individuals and to answer questions.
- Limited parking is available for meeting participants in Visitor's Parking on the P1 level of the garage. There are also public parking facilities close to the Keck Center: Colonial Parking at 6th & Pennsylvania Avenue, N.W.; Diplomat at 932 F St. & E Streets, N.W.; and Carr Park at 601 F St.
- You will need to show your photo ID and COVID-19 vaccination card (or a photograph of the card) to the security officer upon entering the building.
- The workshop will be utilizing Keck 206 as the main conference room for both days while others will be used for breakout sessions.
- Registration, sign in, snacks, and lunch (provided onsite) will be located in the 2nd floor pre function area. See building floor plan below.

Meeting Setup

- Our meeting room is equipped with individual microphones and raised cameras so that the participants joining virtually will be able to see and hear everyone.
- We highly recommend bringing a laptop or tablet where you can join the Zoom meeting in order to view and participate in the zoom chat.
- Email KAldridge@nas.edu with any technical issues during the meeting.

Floor plan

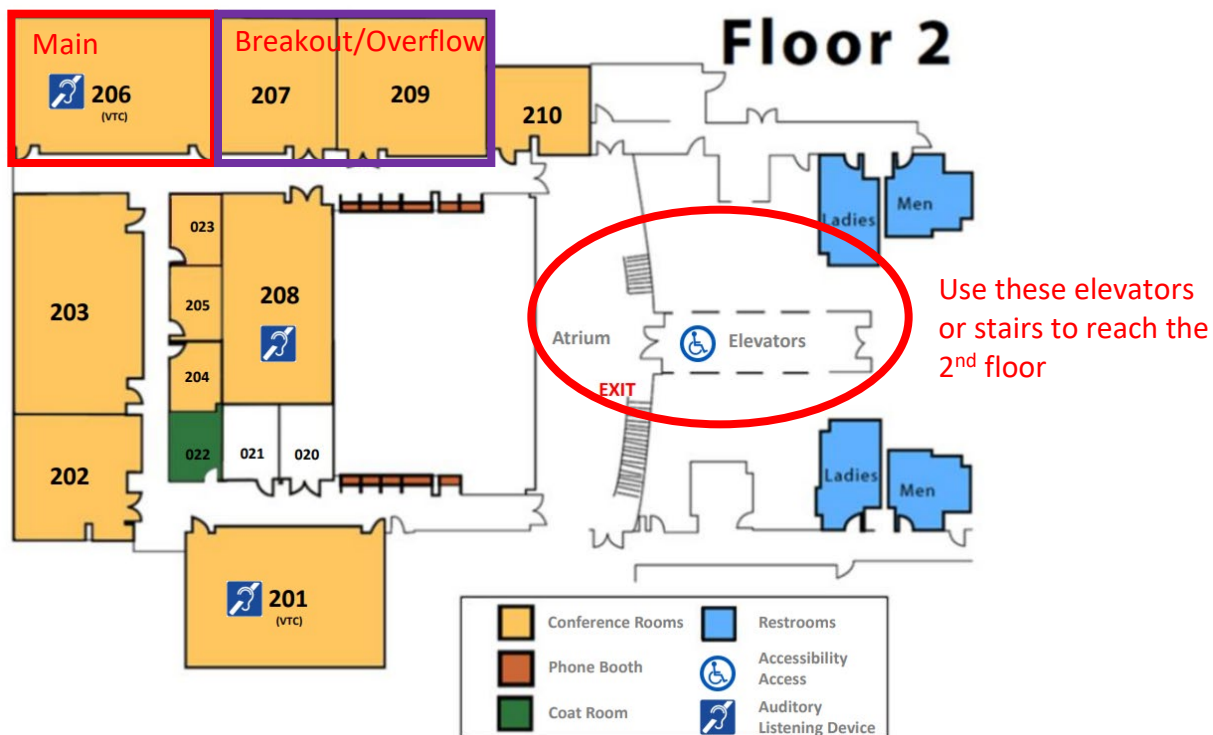

Directions (maps at the end)

By Car from Reagan National Airport

- Exit the airport George Washington Memorial Pkwy. NORTH.
- Exit to Memorial Bridge.
- Bear to the left after crossing Memorial Bridge, passing the Lincoln Memorial, which will be on your right.
- Take second LEFT onto Henry Bacon Dr. N.W. You must turn left at this point as your route will be blocked by Jersey walls.
- Turn RIGHT at the traffic light onto Constitution Ave. N.W.
- Turn LEFT onto Sixth Street, NW
- Cross E St. N.W. and look to your RIGHT for the parking entrance.
- Visitors parking is on the first level of the garage, PI
 - Other Resources:
DCA - Ronald Reagan Washington National Airport Information: <https://www.flyreagan.com/>

By Car from Dulles International Airport

- Exit the airport to Airport Access Rd. EAST.
- Follow until Access Road merges with I-66 EAST.
- Follow I-66 EAST across the Roosevelt Bridge into Washington, D.C. After the bridge, I-66 becomes Rte. 50 EAST/Constitution Ave. N.W.
- Turn LEFT onto Sixth St. N.W.
- Cross E St. N.W. and look to your RIGHT for the parking entrance.
- Visitors parking is on the first level of the garage, PI
 - Other Resources:
IAD - Washington Dulles International Airport Information: <https://www.flydulles.com/>

By Metro's Green or Yellow Line

- Take Metro's Green or Yellow Line to the Gallery Place-Chinatown station.
- Exit the station by following signs to Seventh and F Streets/Arena.
- Turn LEFT and walk EAST on F St. N.W., two blocks past the Verizon Center.
- Turn RIGHT on to Fifth St. N.W.
- Walk past the fire station parking lot. The next building on your RIGHT will be 500 Fifth St. N.W.
- Other Resources:
Metro System Map: <https://washington.org/sites/default/files/ckeditor-images/metro-updated-map-2017.jpg>
- Gallery Place-Chinatown Station Information: <https://www.wmata.com/rider-guide/stations/gallery-place.cfm>

By Metro's Red Line

- Take Metro's Red Line to the Judiciary Square station.
- Exit the station by following signs to the Building Museum (F St.) exit, between Fourth and Fifth Sts. N.W.
- Turn LEFT and walk WEST on F St. N.W.
- Cross Fifth St. N.W. and turn LEFT.
- Walk past the fire station parking lot. The next building on your RIGHT will be 500 Fifth St. N.W.
- Other Resources:
Metro System Map: <https://washington.org/sites/default/files/ckeditor-images/metro-updated-map-2017.jpg>
- Judiciary Square Station Information: <https://www.wmata.com/rider-guide/stations/judiciary-square.cfm>

Entrance to parking garage on 6th Street (limited guest parking on P1)

NATIONAL ACADEMIES

Sciences
Engineering
Medicine



Pedestrian entrance on 5th Street (walking southbound)

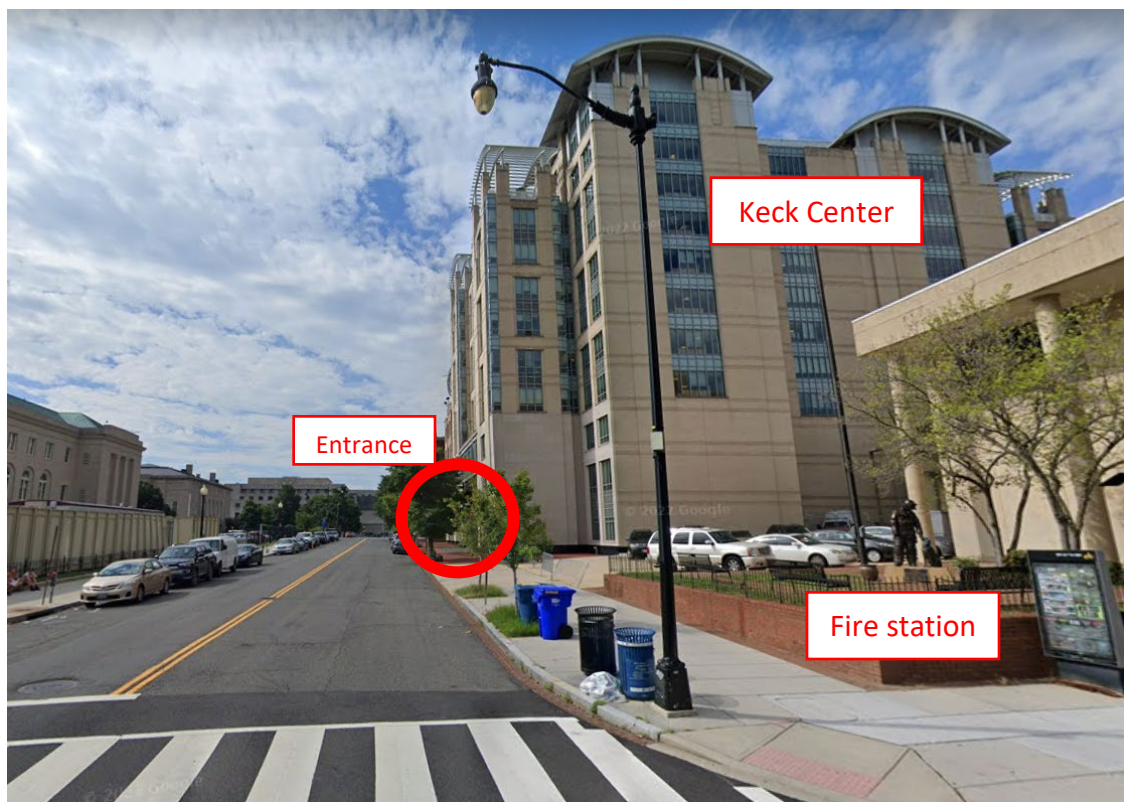

Map

NATIONAL ACADEMIES

Sciences
Engineering
Medicine

Keck Center is between E and F streets, with pedestrian entrance on 5th St. and vehicle entrance on 6th St.

